

(D) EASEMENT TO DRAIN WATER  
 (S) EASEMENT FOR SEWER RISING MAIN  
 (T) RIGHT OF CARRIAGEWAY (TEMPORARY CUL-DE-SAC HEAD)

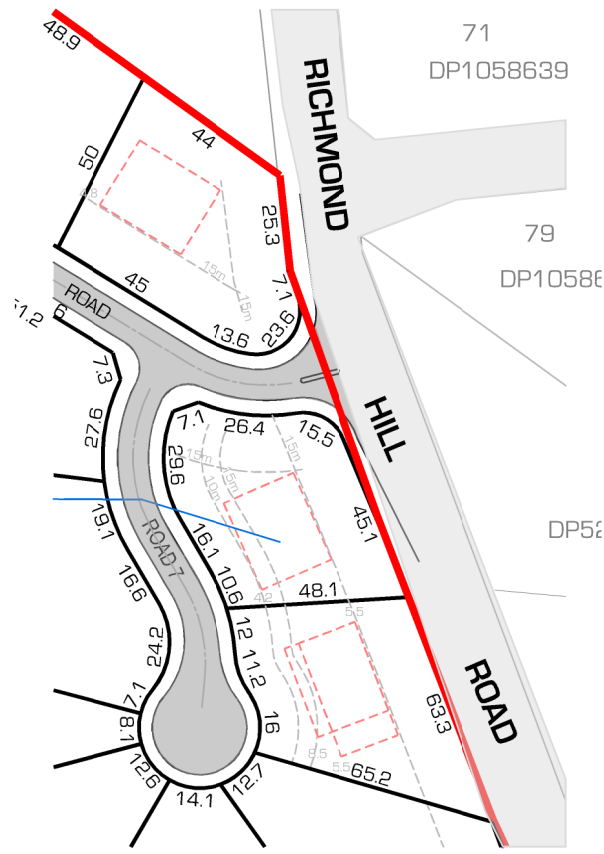

SCALE:  
 1:2000 @ A3

**LEGEND**

- SITE BOUNDARY
- PROPOSED LOT BOUNDARY
- INDICATIVE DWELLING ENVELOPE - 25 X 20m OR 32 X 16m

NOTE: RESIDUAL LAND 36.58ha approx.

NOTE:  
 This preliminary layout has been completed in accordance with the instructions provided by Richmond Hill Holdings P/L. In this respect preliminary desktop data has been used to form this layout. The final layout is subject to the completion of a detailed survey & engineering plans. Accordingly, the conclusions reached within this report may be modified by the author upon the completion of the final design plans & site inspection. Newton Denny Chapelle accepts no responsibility for any loss or damage suffered, however so arising, to any person or corporation who may use or rely on this report.

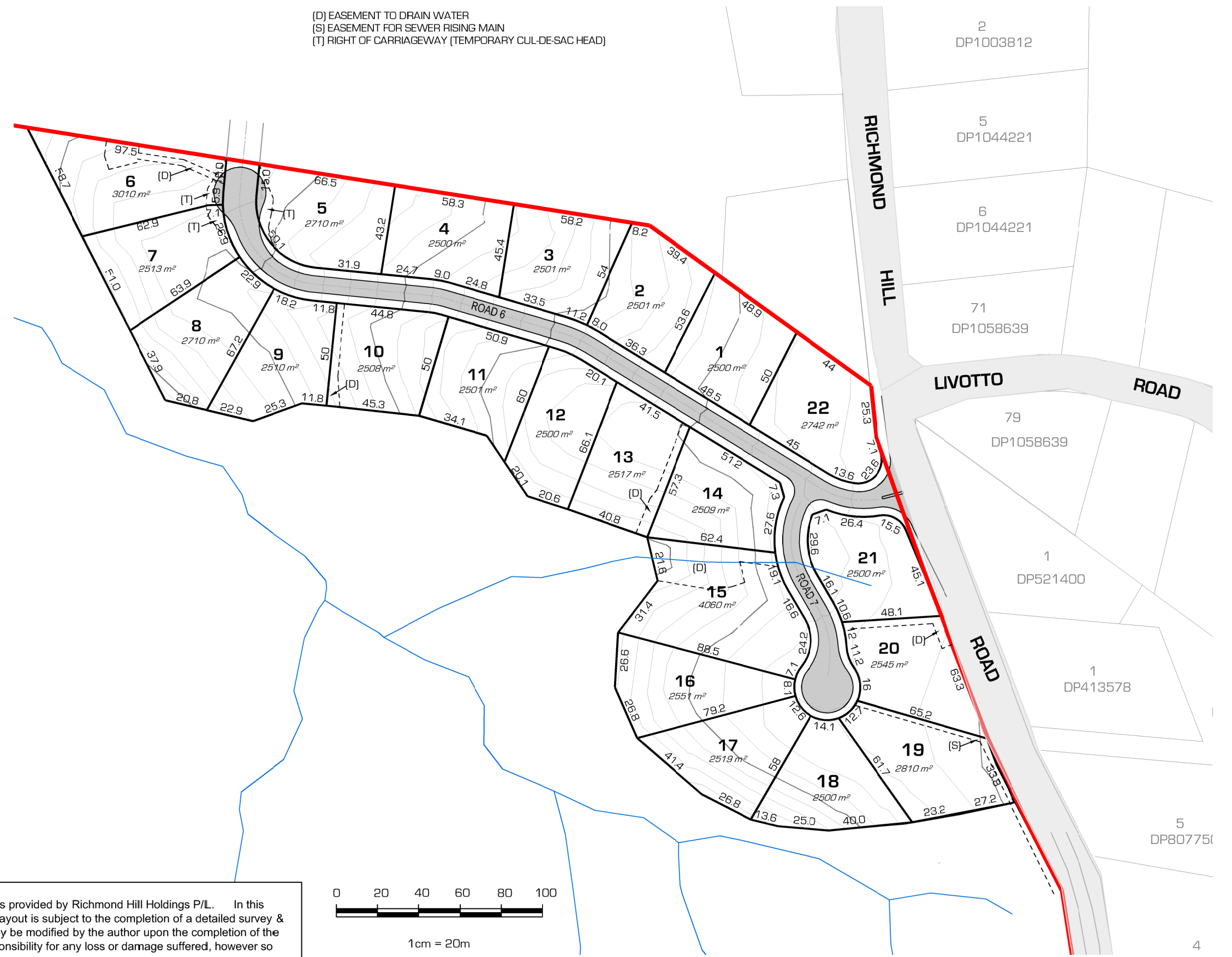
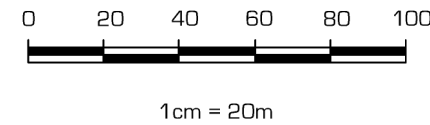

REV	DATE	AMENDMENT
A		
B		
C		
D		
E		



**NDS**  
**Newton Denny Chapelle**  
 Surveyors Planners Engineers  
 Email: office@newtondennychapelle.com.au  
 LISMORE 31 Carrington St. Lismore 2480 PH: 6622 1011  
 CASINO 100 Barker St. Casino 2470 PH: 6662 5000  
 ABN: 86 220 045 469

**PLAN 6 - SUBDIVISION LAYOUT PLAN**

CLIENT:	RICHMOND HILL HOLDINGS P/L Lot 11, 12 & 13 DP 810542 & Lot 1 DP 1136812
LOCATION:	PINEAPPLE ROAD GOONELLABAH NSW
DATE:	24.05.16
SCALE:	1 : 2000 @ A3
REF:	04/652
DRAWN:	ps